

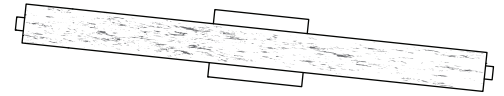

20094/5/6WV



CAUTION - RISK OF FIRE

Installation of this fixture should be done by a licensed electrician or by a person familiar with local electrical codes and the construction and operation of this fixture.

Warning please make sure the electrical breaker is shut off before commencing with this installation

Read and familiarize yourself with these instructions before commencing

This fixture is certified for wall mounting only and is suitable for Damp locations and dimmable with a Triac Dimmer

The fixture uses a 120v A/C LED panel which is supplied with a clear glass cover plate, no driver required

Package Contents		
Part	Description	Qty
A	Fixture mounting plate	1
B	J-Box mounting bolts	2
C	Plastic wall anchors	2
D	Wall anchor screws	2
E	Wire connectors	3
F	Fixture assembly	1
G	Glass diffuser	1
H	End caps	2
I	End cap mounting screws	2
J	Fixture mounting screws	4

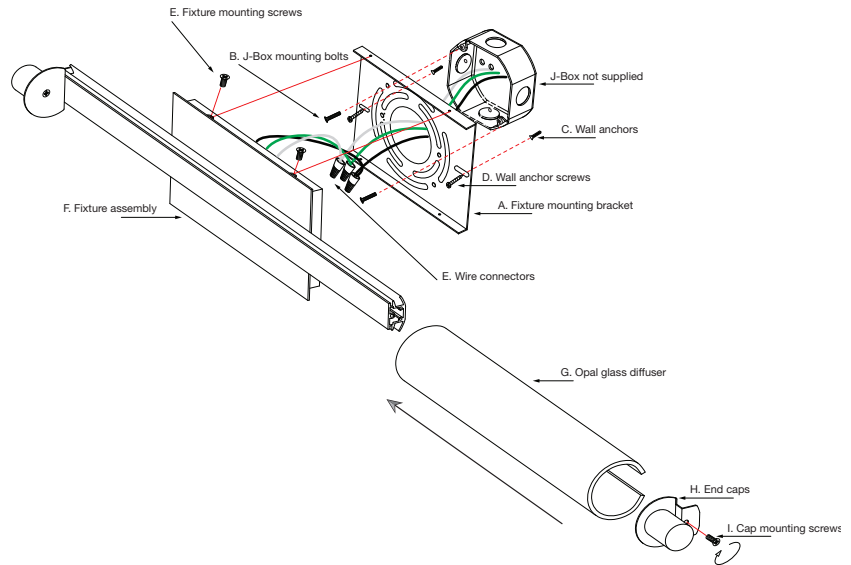

Installing the fixture *please ensure the electrical breaker is switched off before commencing*

1	<p>Mark the location of the angle which the fixture will be installed by loosely attaching the Fixture mounting plate (A) to the Junction-Box and mark the position of two holes required for the supplied anchors. (C). Remove the Universal mounting plate and drill two holes on these marks and insert the Plastic anchors. Re-attach the Fixture mounting plate with the two supplied mounting bolts (B) to the Junction-Box and insert the supplied Anchor screws (D) into the Plastic anchors and securely tighten.</p>	
2	<p>Gently attach the glass diffuser (G) by sliding it over the aluminum bar rail attached to the fixture assembly (F). Attach the end caps (H) to each end of the fixture assembly (F) and secure with supplied screws (I).</p>	
3	<p>Connect the supply wires to the fixture wires using the supplied electrical wire connectors (D). White supply wire to the White fixture wire, Black supply wire to Black fixture wire and the ground Bare Copper or Green wire to the Green fixture wire. Once the electrical wire connectors are securely fastened it is recommended to tape these connectors with electrical tape.</p>	
4	<p>Attach the fixture assembly (C) to the mounting bracket (A) and secure with supplied screws (E)</p>	
5	<p>Switch on the electrical breaker and your new fixture is ready for many years of trouble free use</p>	